

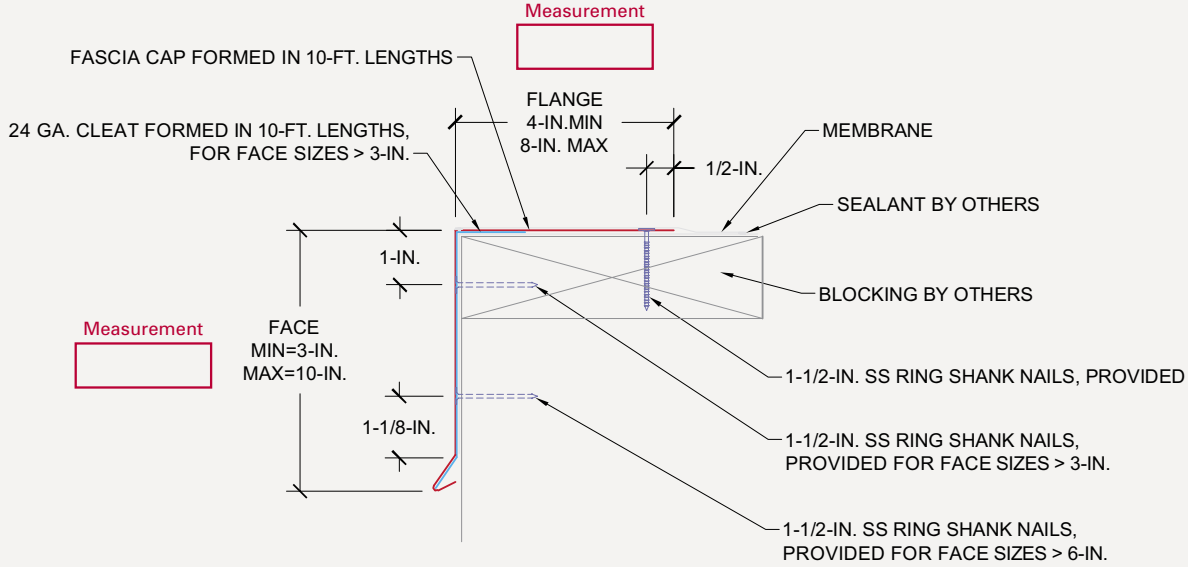

# Roofers Edge Drip Fascia

## ORDER SPECIFICATION FORM

ANSI/SPRI/FM4435/ES-1 TEST PRESSURES UP TO 266 PSF (HORIZONTAL)



FOR MASONRY APPLICATIONS, PLEASE CONTACT US.

CONTACT US FOR APPROPRIATE RECOMMENDATIONS NEEDED TO MEET/EXCEED ANSI/SPRI/FM4435/ES-1 DESIGN CRITERIA

<b>QUANTITY</b>			<b>CUSTOMER APPROVAL</b>		
Straight Length			Approved for Fabrication    Approved with Changes    Not Approved		
<b>FACE HEIGHT</b>		<b>COLOR</b>			
<input type="text"/>		<input type="text"/>			
<b>COVER MATERIAL</b>	<b>THICKNESS</b>	<b>COVER FINISH</b>			
Aluminum Galvanized Steel	24Ga. .040 in.	Mill Prefinished Kynar Premium Prefinished Kynar			
<b>APPROVALS</b>			Title _____ Date _____		
<div style="border: 1px solid black; padding: 2px; display: inline-block;">ANSI/SPRI/FM 4435 /ES-1 TESTED</div>			Authorized Customer Signature _____		
			Job Name: _____		
			Project Location: _____		
			Customer: _____		
			Representative: _____		



## EdgeSystems

4 COMMERCE WAY, ARDEN NC 28704 USA  
800-892-9173 828-676-1700 [OMGROOFING.COM](http://OMGROOFING.COM)

Copyright © 2020 OMG, Inc. All rights reserved.

Superior productivity.  
Superior performance.

